



Hoisting Equipment

Pneumatic hoists and winches

Safety with compressed air

new!



Hoisting Equipment

Pneumatic hoists and winches

Information

Yale Industrial Products GmbH

of Velbert belongs to a worldwide operating enterprise in the field of lifting equipment. We manufacture and distribute a comprehensive range of hoists, cranes and lifting clamps, textile slings and ratchet lashings, dynamometer systems and crane weighers as well as a wide range of hydraulic jacks and tools.

Qualified personnel at the Yale locations in Germany, the U.K., France, Austria, the Netherlands, Spain, Hungary and South Africa together with a distribution network throughout Europe, America and Asia provide competent know-how and service.

Yale's comprehensive distribution system and logistics ensure short lead times and availability on international basis. Fully dedicated to market requirements and constant product innovation Yale Industrial Products GmbH has built up a strong brand recognition and leading market position for hoists and related lifting products.



Yale pneumatic hoists

With more than 130 years experience in the design and manufacture of hoisting equipment the Yale pneumatic hoists and winches are the logical extension to existing range of quality products.

Robust and versatile

Air driven, as opposed to electric motors, do not create sparks. This exceptional feature makes pneumatic hoists and winches especially suitable for areas where there is a danger of explosion. They are designed for 100% duty rating and an unlimited number of starts. The versatility of air hoist is virtually unlimited even at extreme temperatures (-20° C up to +70° C) or in the presence of high humidity or steam.

Available with either top hook suspension or manual trolleys. Capacities from 2000 kg and above are also available with integrated pneumatic trolley.

Precise and sensitive

The sensitive push button control allows lifting and lowering speeds to be finely metered. Thus a precise and infinitely variable load positioning is ensured.

High productivity

Lifting speeds up to 15 m/min. The economical design concept contributes to ease of maintenance and service and minimizes possible downtime, thus saving costs and spare parts requirements.

Applications

Foundries, on-/offshore, mining, handling of paint and varnish, refineries, oil depots, galvanizing, automobile and aircraft factories, in shipyards and on ships and docks, printing industry, pulp and paper mills, textile industries, food industries, glass and ceramic industries, wood working industries and heat treatment plants, chemical and pyrotechnical industries, cement mills, power plants etc.

Hoisting Equipment

Pneumatic chain hoist

CPA

Pneumatic chain hoist

Model CPA

Capacities 125 - 990 kg

The motors with integrated brake function are designed for continuous operation with unlimited number of work and duty cycles. These units excel through their extremely quiet operation and robust aluminium housing. Low and easy maintenance due to reduced number of components. On account of its compact, lightweight design and low headroom the CPA is very handy and easy to carry.

- Operating pressure 6 bar
- Suitable for operation in hazardous areas according to  II 3 GD IIA T4
- Extremely sensitive direct control with emergency stop. Max. control drop 6 m.
- Chain containers up to 8 m lifting height are included as standard.

Optional

- Manual trolleys for top hook suspension of pneumatic chain hoists.
- Pressure limiting valves to prevent unintentional overloading.
- Maintenance unit for main air supply pipe (Pressure regulator, manometer, lubricator and support)



Model	Capacities in kg/ Number of chain falls	Lifting speed with rated load* m/min	Lifting speed without load* m/min	Lowering speed with rated load* m/min	Air consumption with rated load* m ³ /min	Motor kW	Weight for standard 3 m lift kg
CPA 1-15	125/1	15	40	30	0,5	0,4	9,5
CPA 2-8	250/1	8	20	16	0,5	0,4	10,5
CPA 5-10	500/1	10	20	18	1,2	1,0	21
CPA 10-5	990/1	5	10	10	1,2	1,0	23

* Values for 6 bar (flow pressure) and 2 m control drop.
Speeds will be reduced in case of longer control length.

Dim. in mm	CPA 1-15	CPA 2-8	CPA 5-10	CPA 10-5
A	328	328	458	458
A ₁	210	210	290	290
B	17	17	26	26
C	19	19	28	28
D	13	13	22	22
F ₁	92	92	122	122
F ₂	92	92	122	122
G	115	115	155	155
G ₁	83	83	119	119
G ₂	148	148	194	194
H ₃	30	30	45	45
K ₁	30	30	50	50
M	20	20	25	25
N	29	29	40	40
Q ₁	104	104	144	144
Q ₂	109	109	148	148

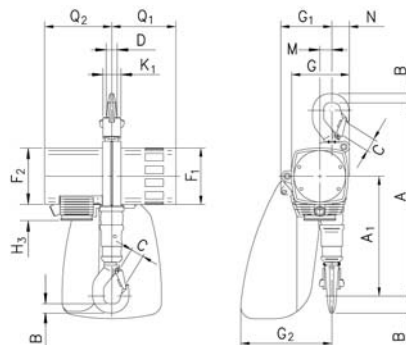

Hoisting Equipment

Pneumatic chain hoist

CPA



Higher capacities and special models on request!

Pneumatic chain hoist

Model CPA

with top hook suspension, manual push and geared trolleys as well as pneumatic trolleys

Capacities 2.000 - 6.000 kg

The standard, oil bath lubricated planetary gearbox is particularly smooth running and contributes to the overall low headroom.

With 100% duty rating and an unlimited number of starts in combination with a robust design, the unit is suitable for heavy duty applications.

- Operating pressure 4 - 6 bar
- Sensitive indirect control by means of 2 resp. 4 button pendant control with emergency stop
- Low noise emission due to large dimension silencer

Optional

- Chain container
- Pull cord control
- Direct control
- Stainless steel load chain
- Bronze-plated top and load hooks
- Maintenance unit for main air supply pipe (Pressure regulator, manometer, lubricator and support)

Model	Capacities in kg/ Number of chain falls	Lifting speed with rated load* m/min	Lifting speed without load* m/min	Lowering speed with rated load* m/min	Motor kW	Weight for standard 3m lift**			
						Suspension hook kg	Push trolley kg	Geared trolley kg	Pneumatic trolley kg
CPA 20-8	2000/1	7,4	10	11	2,6	121	184	188	199
CPA 30-6	3000/1	6,0	10	13	3,2	121	184	188	199
CPA 40-4	4000/2	3,7	5	5,5	2,6	140	202	206	218
CPA 50-3	5000/2	3,4	5	6,0	3,0	140	202	206	218
CPA 60-3	6000/2	3,0	5	6,5	3,2	140	202	206	218

*Values for 6 bar (flow pressure) and 2 m control drop. Speeds will be reduced in case of longer control length. Air consumption with rated load 4,7m³/min.

**Other lifting heights available.

Pneumatic trolleys

Capacity kg	Flange width mm	Size	Curve radius min. m	Pneumatic trolley	
				Travel speed m/min	Motor kW
2000 - 6000	98 - 180	A	1,8	18	0,55
2000 - 6000	180 - 300	B	1,8	18	0,55

Dim. in mm	Pneumatic chain hoist CPA with top hook				
	CPA 20-8	CPA 30-6	CPA 40-4	CPA 50-3	CPA 60-3
A	516	516	681	681	681
A ₁	286	286	428	428	428
B	35	35	45	45	45
C	37	37	46	46	46
D	24	24	30	30	30
F ₁	160	160	160	160	160
F ₂	165	165	165	165	165
G	220	220	220	220	220
G ₁	180	180	140	140	140
G ₂ (13 m)	258	258	218	218	218
G ₂ (21 m)	278	278	238	238	238
H ₁	110	110	110	110	110
H ₂	135	135	135	135	135
H ₃	115	115	115	115	115
K ₁	100	100	100	100	100
K ₂	51	51	51	51	51
M	50	50	9,6	9,6	9,6
N	60	60	100	100	100
Q ₁	272	272	272	272	272
Q ₂	325	325	325	325	325

Dim. in mm	Pneumatic chain hoist CPA with integral trolley				
	CPA 20-8	CPA 30-6	CPA 40-4	CPA 50-3	CPA 60-3
A ₂ (13 m)	430	430	430	430	430
A ₂ (21 m)	530	530	530	530	530
A ₄	465	465	615	615	615
A ₅	298	298	298	298	298
A ₆	190	190	190	190	190
b	A = 98 - 180 / B = 180 - 300				
F	150	150	150	150	150
I	142,5	142,5	142,5	142,5	142,5
L ₁	209	209	209	209	209
L ₂	262,5	262,5	262,5	262,5	262,5
L ₃	265	265	265	265	265
L ₄	213	213	253	253	253
L ₅	312	312	272	272	272
L ₆	315	315	275	275	275
O	125	125	125	125	125
P	208	208	208	208	208
P ₁	284	284	284	284	284
S	b + 70	b + 70	b + 70	b + 70	b + 70
t	27	27	27	27	27
T Size A	182	182	182	182	182
T Size B	242	242	242	242	242

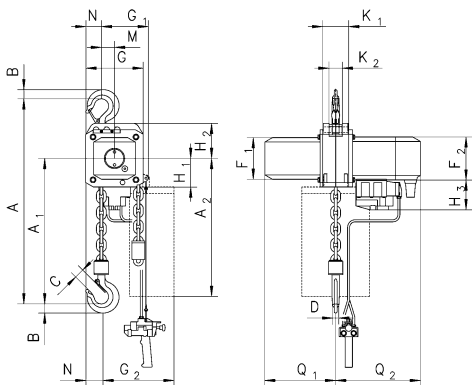

Model CPA with hook suspension, single fall

2.000 - 3.000 kg

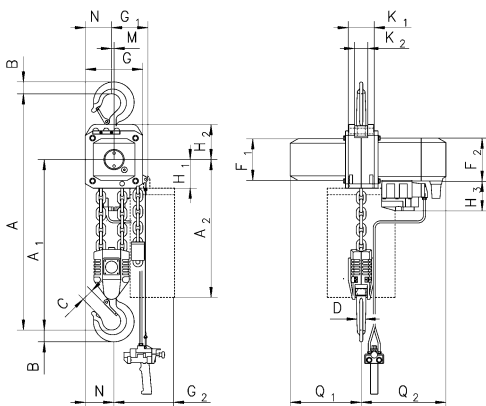

Model CPA with hook suspension, double fall

4.000 - 6.000 kg

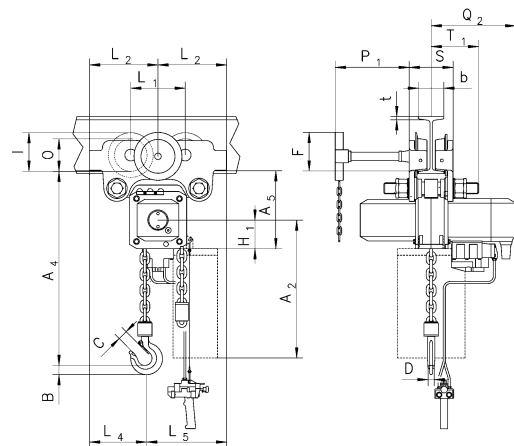

Model CPA with integral manual push or geared trolley

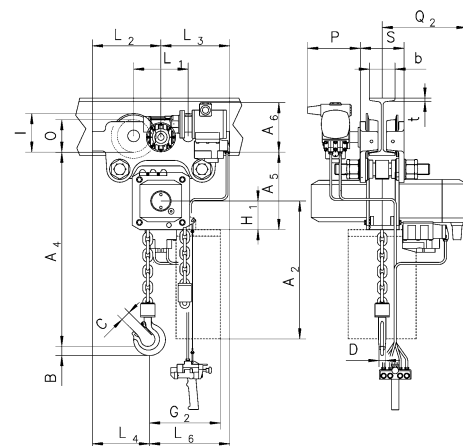

Model CPA with integral pneumatic trolley

Hoisting Equipment

Pneumatic wire rope winch

RPA

Pneumatic wire rope winch

Model RPA

Capacities 250 - 500 kg

The robust and compact cube shape design as well as the universal rope lead-off allow applications in almost any position. With 100% duty rating and an unlimited number of starts the model RPA is suitable for heavy duty applications.

- Robust rotating piston motor, operating pressure 4-6 bar
- Spring pressure disc brake incorporated in the motor
- Sensitive control by means of direct acting valves in the control switch.

Optional

- Different drum designs (extended, machined grooves and separation webs)
- Adjustable slip clutch to prevent the winch from overloading
- Control with pendant, 2,5 m hose and air pressure coupling
- Maintenance unit for main air supply pipe (Pressure regulator, manometer, lubricator and support)



Model	Pulling force in the upper layer daN	Lifting speed with rated load* m/min	Lifting speed without load* m/min	Lowering speed with rated load* m/min	Useable rope length in the upper layer in m	Motor kW	Weight without rope kg
RPA 2-13	250	12,5	20,0	22,0	54,5	0,55	36,7
RPA 5-6	500	6,2	10,0	11,0	38,8	0,55	36,7

*Value for 6 bar, Air consumption 0,75 m³/min

To ensure faultless operation the compressed air supply must be filtered and oiled!



Option: different drum designs



Rope attachment



Option: Gearbox with slipclutch

Dim. in mm	RPA 2-13	RPA 5-6
A	405	405
B	375	375
C	18	18
D _{TR}	76	76
D _{max}	104	118
D _A	150	150
E	336	336
F	210	210
G	260	260
H	290	290
I	11	11
K	250	250
L	125	125
M	6	6
N	33	33
O	194	194
P	19	19
Q	13	13
R	125	125
S	4	6
α ₁	130°	130°
α ₂	90°	90°
α ₃	20°	20°
β ₁	150°	150°
β ₂	70°	70°
β ₃	60°	60°

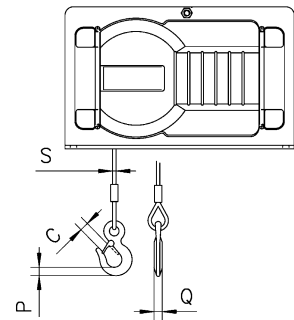
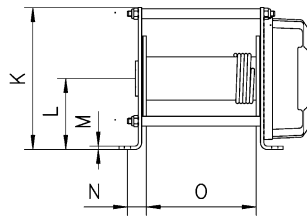
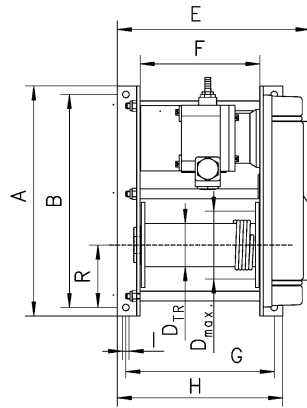

Plain standard drum (longer useable rope length)

Pulling force in all layers daN	Lifting speed upper layer m/min.	Drum size	Max rope length upper layer m
250	13,0	2	80
500	6,5	2	58
250	13,0	3	200
500	6,5	3	140
500	12,0	3	140

**Grooved drum (larger drum diameter)
only for single layer operation**

Pulling force in all layers daN	Lifting speed upper layer m/min.	Drum size	1 st layer/m
250	13,0	1	8,6
500	6,5	1	5,8
250	13,0	2	15
500	6,5	2	10,7
250	13,0	3	44
500	6,5	3	31

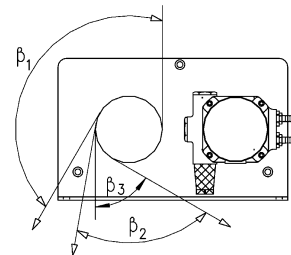
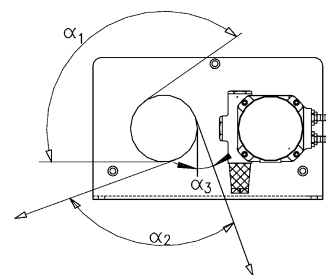

Rope lead-offs for pneumatic rope winch RPA



Yale® Hoisting Equipment

- Ratchet lever hoists
- Hand chain hoists
- Electric and pneumatic chain hoists
- Travel trolleys and beam clamps
- Cable pullers and accessories
- Electric and pneumatic winches

Yaletex Textile Lifting Slings and Lashing Equipment

- Round slings
- Flat webbing slings
- Ratchet lashings

TIGRIP® Load Hoisting Tackle and Crane Weighers

- Clamps
- Grabs
- Spreader beams
- Crane forks
- Crane weighers

Steerman® Load Moving Systems

Hydraulic Jacks and Tools

- Hydraulic cylinders 5-1.100 tonnes
- Hand and motor pumps up to 700 bar
- Universal and machine jacks
- Hydraulic puller sets
- Workshop presses up to 200 tonnes
- Accessories and complete hydraulic systems

Yalesystems

- Wall-mounted Jib cranes
- Floor-mounted Jib cranes
- Gantry cranes
- Crane systems



Certified since November 1991

Your local distributor: